

## DO

- DO observe the handling instructions on the label
- DO check that the discharge spout is closed off before filling
- DO ensure that the filled FIBC is stable
- DO close the top inlet correctly
- DO inflate the liner prior to filling
- DO take appropriate measures in regard to dust control
- DO use lifting gear of sufficient capacity to take the suspended load
- DO ensure that the edges of the fork lift tines are smooth, or protected
- DO adjust the fork lift tines to the correct width for the FIBC being handled
- DO keep the fork lift tines on the fork lift level
- DO ensure that crane hooks are of adequate size and well rounded
- DO consider the possibility and effects of static electricity
- DO protect the FIBCs from rain and prolonged sunlight
- DO ensure that FIBCs are adequately secured in transportation
- DO dispose of FIBCs in accordance with ecological requirements

## DON'T

- DON'T exceed the Safe Working Load under any circumstance
- DON'T fill FIBCs unevenly
- DON'T stop or start suddenly during transportation
- DON'T subject FIBCs to sudden lifts or stops
- DON'T allow personnel under suspended FIBC
- DON'T allow FIBC to project over the side of a vehicle or pallet
- DON'T tilt the mast of the fork lift forward
- DON'T withdraw fork lift tines prior to relieving all the load on the lifting device
- DON'T stack FIBCs unless sure of stability

FIBCA recognises that bulk bags with appropriate user handling and inspection can be used for multiple trips and has adopted the ISO/DIS11895 standard as a minimum design recommendation.

phone 01422 373261

fax 01422 374823

email [sales@rosenflex.com](mailto:sales@rosenflex.com)

website [www.rosenflex.com](http://www.rosenflex.com)

## Safety Guidelines for Handling of FIBCs

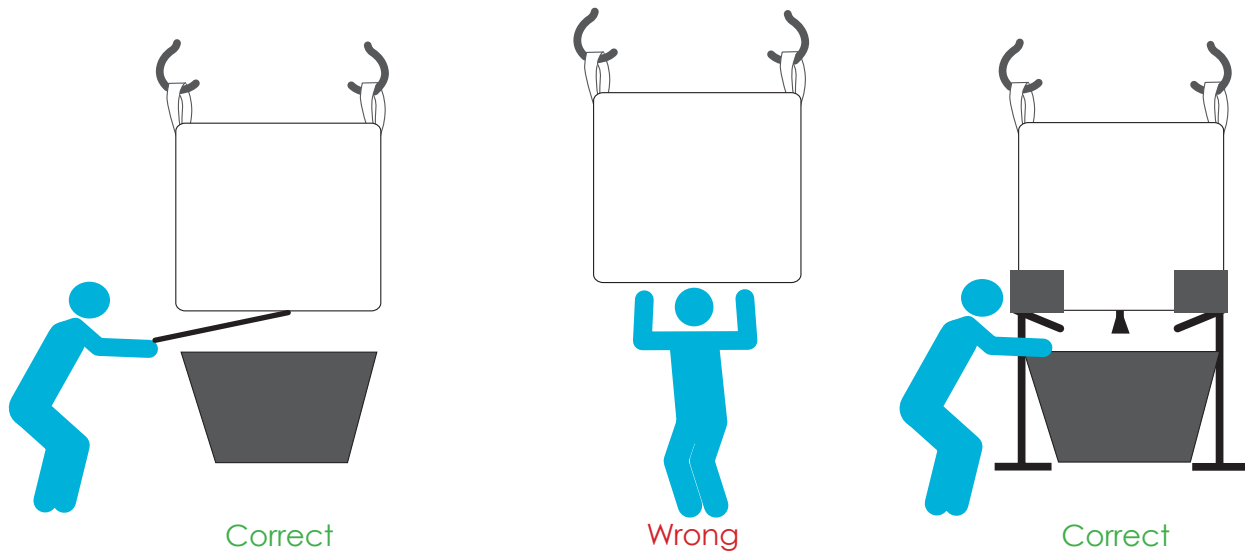

### Stacking of Filled FIBCS

When stacking filled FIBCs 2 or more high, every effort should be made to ensure that the stack is stable. Where possible, the stack should be formed against at least two retaining walls, preferably 3, to achieve maximum stability. Generally, the higher the stack, the greater number of retaining walls required.

Where only free stacking is possible, a pyramid method should be used

FIBCs should not be pushed into a stack as this can cause damage to the sides or back of the FIBC

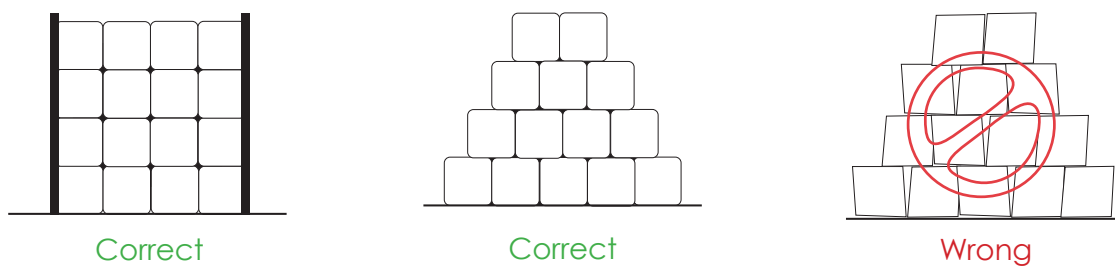

### Storage of Filled FIBCS

If FIBCs are stored outside, attention should be paid to the top closure. Be sure the top closure is properly tied off. FIBCs should be covered with waterproof, U.V protected material to avoid water collecting on the top of the FIBC and to prevent damage from sunlight.

Be sure that FIBCs are not standing in water.

### Hazardous Materials

Special care should be taken when handling bags with UN or DOT regulated materials. For questions concerning the material, refer to the suppliers MSDS. Questions concerning FIBCs should be referred to your Rosenflex contact.

### Explosive Materials and Areas

If FIBCs are to be filled or emptied in flammable or explosive atmospheres, special features such as anti-stat material should be utilized. Rosenflex can make recommendations for use in these areas.